

Emotion Recognition with Forearm-based Electromyography

Muhammad Shihab Rashid^a, Zubayet Zaman^b, Hasan Mahmud^c, Md. Kamrul Hasan^d

Department of Computer Science and Engineering, Islamic University of Technology, Boardbazar, Gazipur, Bangladesh

ABSTRACT

Electromyography is an unexplored field of study when it comes to alternate input modality while interacting with a computer. However, to make computers understand human emotions is pivotal in the area of human-computer interaction and in assistive technology. Traditional input devices used currently have limitations and restrictions when it comes to express human emotions. The applications regarding computers and emotions are vast. In this paper we analyze EMG signals recorded from a low cost MyoSensor and classify them into two classes - Relaxed and Angry. In order to perform this classification we have created a dataset collected from 10 users, extracted 8 significant features and classified them using Support Vector Machine algorithm. We show uniquely that forearm-based EMG signal can express emotions. Experimental results show an accuracy of 88.1% after 300 iterations. This shows significant opportunities in various fields of computer science such as gaming and e-learning tools where EMG signals can be used to detect human emotions and make the system provide feedback based on it. We discuss further applications of the method that seeks to expand the range of human-computer interaction beyond the button box.

KEYWORDS

electromyography; emotion; assistive technology; human-computer interaction

1. Introduction

Electromyography means the recording of the electrical activity of muscle tissue, or its representation as a visual display or audible signal, using electrodes attached to the skin or inserted into the muscle. Human body is comprised of lots of nerves and sensors and they pass electric signals throughout the body. Electromyography is the study of these signals and how these impact different aspects.

Emotions are very crucial in our day to day lives as it can heavily influence our mood and affect our communication with others. For a long time, scientists have been trying to make computers understand our emotions. If computers can understand emotions and if they can provide feedback based on it, then the user experience while interacting with a system will be more natural. While the demand for newer and alternate method for interaction is rising high, we see methods such as body-worn computer systems, but the question of ideal input mechanism is still unanswered. Traditional input devices such as keyboard, mouse, joystick are monotonous and have restricted applications. The user experience regarding these traditional devices are very limiting. With the invent of technology we see input methods such as touch and gesture, but

due to lacking of quality of cameras or algorithm accuracy, these methods cannot fully detect gestures. As a result the user experience may become cumbersome and tiring. So researchers started to think of even newer ways to interact with a computer. A combination of speech and gesture seemed promising, as speech is more natural and gestures are suited for spatial or silent and harmless interaction. The applications of these methods include controlling smart glasses or watches with subtle finger motions and gestures. But due to noise in speech data this method posed a problem. So these problems gave way to latest input mechanisms such as bio sensors which include EEG(Electroencephalography), EMG and GSR(Galvanic Skin Response). These are newer fields in the area of interaction and are still unexplored.

Electromyography to this day, have been used for clinical diagnosis and biomedical applications mostly(Reaz, Hussain, & Mohd-Yasin, 2006). The field of rehabilitation of motor disabilities is a key area for EMG signals. The shapes and firing rates of Motor Unit Action Potentials (MUAPs) in EMG signals provide an important source of information for the diagnosis of neuromuscular disorders. So far research and extensive efforts have been made in the area to develop better algorithms, upgrading existing technologies, improving detecting mechanism and to acquire accurate data. Another application of EMG includes in the field of Robotics where artificial hand control and movement, grasp control etc. However, EMG is yet to be used as an input modality in interaction and our paper proposes that as EMG can convey emotions, the machine can give accurate responses.

We believe the process is more natural when we try to convey emotions using muscles. As it is dependent on our reflexes, when we are in an emotional state, our muscles automatically give responses based on a certain emotion. For which the responses can be more or less accurately recorded by sensors. We thought the responses might follow a pattern in case of all the individuals so we did the experiment and got promising results.

The potential application of our method includes emotion-based game difficulties. Sometimes the gamers feel stressed while playing games and this may cause health difficulties and may change the mood. EMG can be used to detect user stress level or emotion status while playing the game and based on the status, the computer can change the difficulty level. For example, when the user gets stressed, the game level may offer an extra booster so the player can control his or her stress level. Our method can also be integrated with virtual reality technologies where user emotion adds an extra layer to the user experience.

2. Related Works

There are different classification systems for emotion. According to Plutchik(Plutchik, 2003) emotion can be of eight types. Anger, fear, sadness, disgust, surprise, anticipation, acceptance and joy. All other emotions can be formed by mixing these basic emotions. The most widely used system is Russel's bipolar system where emotion is classified into two categories: Arousal and Valence(Russell, 1979). Arousal ranges from sad/angry to excited/joyful and valence ranges from negative to positive. In this paper, we have chosen two contrasting emotions such as Angry and Relaxed so that we can differentiate between the emotions. The second reason being, in the applications of EMG such as in gaming, people usually express these two types of emotions.

In the Figure 1, we can see the two dimensional valence arousal matrix. Where emotions such as Happy or excited are regarded as high valence emotions and being upset

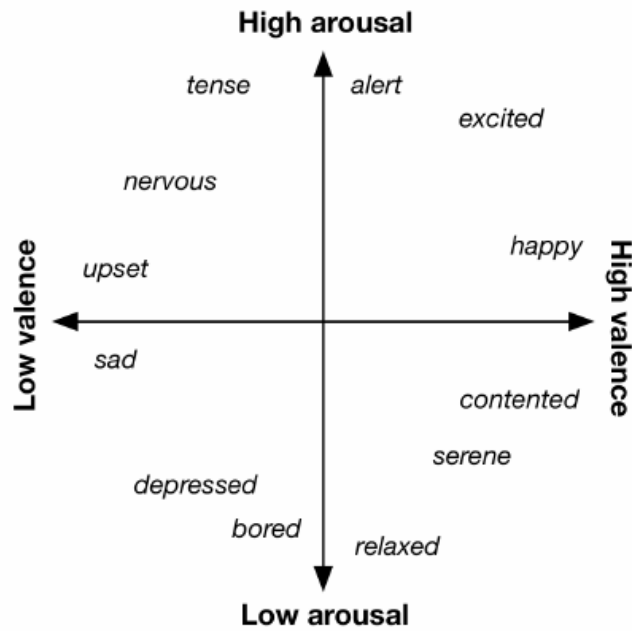

Figure 1. Valence Arousal Matrix

or sad is regarded as low valence emotion. High arousal emotions are alert and tense and low arousal emotions are relaxed.

Although detection of human emotions in the area of human-computer interaction is a newer methodology itself, there are some significant research done in this area. However, whether emotion detection can be done through electromyography data is still to be answered. Similar mechanisms have been used in detecting emotions in recent years.

Firstly, as per human anatomy, brain is the most fundamental source of emotion and best way to measure the neurological changes. This type of process is called Electroencephalography or EEG. In recent years MRI also shows great promise in detecting human emotion. In (Liu, Sourina, & Nguyen, 2010)(Mikhail, El-Ayat, El Kaliouby, Coan, & Allen, 2010) authors show that using a brain signal sensor, emotions can be detected in the valence-arousal two dimensional model. But the author proposes some challenges in working with brain sensors. The sensors are noisy as our brain handles different functions at a certain point in time. So the separation of noise with actual data is quite difficult.

Secondly, facial muscles or expressions plays a vital role for both verbal and nonverbal communication. Due to changes in mental state, users facial expressions also change, but these expressions are somewhat forced, it does not happen naturally. The added challenge of analysis and processing of huge data with complex algorithms to generate probable emotion is difficult to implement in smaller hardware or devices. So a more convenient way is necessary.

Third, audio signals or voice can also play a part. Users vocal chords can carry significant variations or emotional information. From the pitch, intensity and pitch contours are estimated. Speech data most of the times do not correlate with the meaning the user intended to say. Most times it is misinterpreted by computer.

Newer ways of emotion recognition such as haptic feedback (Salminen et al., 2008)

which is based on users touch input seem promising (Alenljung, Andreasson, Billing, Lindblom, & Lowe, 2017)(Huisman & Frederiks, 2013). However, users touch contain very little information regarding emotional activity which proposes as a problem. In (Hossain, Sadat, & Mahmud, 2014) the authors propose that emotions can be expressed depending on users sitting position and also using smartphones different sensors. These methods are dependent on the user having a smartphone or sitting at a certain position. Fusing all these methods together creates a multimodal emotion recognition system. The multimodal approach is a lot more dynamic but it has to correlate multiple types of inputs and finally integrate with probabilistic models. In (Girardi, Lanubile, & Novielli, 2017)(Hui & Sherratt, 2018) they used a combination of biological sensors such as EEG, EMG and GSR or biological gloves to detect emotions. Their study does not portray the possibility of detecting emotion just based on EMG data.

Regarding applications of this research domain, in (Crawford, Vavra, & Corbin, 2017) they have built a device also using myosensors to interact with a computer using facial muscles and facial mimicry. But these approach has limiting nature because it only uses facial muscles where the muscle movements are strict.

2.1. Feature Extraction, Selection

Even though forearm-based EMG signals have not been used to classify emotions but EMG signals in general have been used in different researchs. In (Cheng & Liu, 2008) they have extracted features using wavelet transform. In (Reaz et al., 2006), there are around 50 types of features described in the time domain and the frequency domain. In (Daud, Yahya, Horng, Sulaima, & Sudirman, 2013), the authors tried to extract features based on the biceps muscle. The have extracted the following three features: Maximum amplitude, Standard Deviation and Root Mean Square.

2.2. Studies Regarding EMG

Although forearm-based Electromyography has not been used to detect emotion or been used in human computer interaction applications, there has been studies regarding EMG. In (Saponas et al., 2009) they have shown how forearm EMG can be used to detect and decode human muscular movement in real time, thus enabling interactive finger gesture interaction. They have also explored techniques that will enable people to interact with computers when their hands are unencumbered but a hand-held device is impractical.

In (Haque, Nancel, & Vogel, 2015) they have developed a mid-air, free hand pointing and clicking interaction mechanism using electromyographic (EMG) and inertial measurement unit (IMU) input from a consumer armband device. They have shown significant improvement when clicking and pointing with Myo devices. Also, this indicates, myo devices can be a modality of interaction with computers. Although they have shown this in a limited scale, it is an indicator that there are vast possibilities of EMG being used as an interaction modality.

In (Saponas, Tan, Morris, & Balakrishnan, 2008) they have shown, using a Muscle Computer Interface (muCIs), gestures can be classified using an off-the-shelf electromyography device. They were able to differentiate position and pressure of finger presses, as well as recognizing tapping and gestures of lifting across all the fingers of one hand. In (Amma, Krings, Böer, & Schultz, 2015) they used a sensor array based

muscle-computer interface for gesture recognition. These studies show that, EMG can be a viable interaction method.

3. Proposed Approach

We propose an emotion recognition system through EMG signals. The architectural diagram is given in Figure 2. In general, the proposed system consists of the following steps:

- Data collection
- Pre-Processing
- Feature extraction and selection
- Training set generation
- Classification using SVM

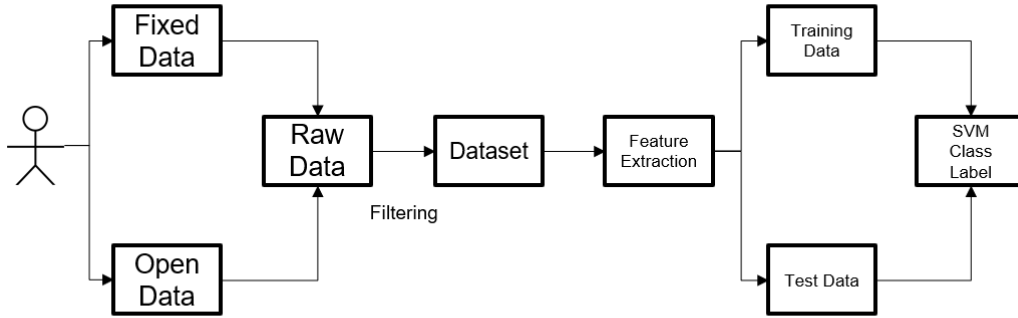

Figure 2. Architectural Diagram of Proposed Approach

3.1. Experiment Setup

For conducting the experiment, we built a wearable device using low cost MyoWare Muscle sensor by Advancer Technologies and an Arduino Mega board. The muscle sensor device has three bio-sensor electrodes of which one is used as a reference electrode. The device can be worn on any body part that contains muscle, but placing it on the forearm gives the most accurate results. A simple AnalogReadSignal function was used using Arduino software to capture the sensor readings. In Figure 2 we can see the myoware device put on the forearm. The wire is connected to the Arduino mega board. The device is very small in size so it has better mobility than other traditional devices.

3.2. Data Collection

We have selected 10 university going individuals consisting of both male and female as our users. The wearable device was placed on the forearm of the users dominating

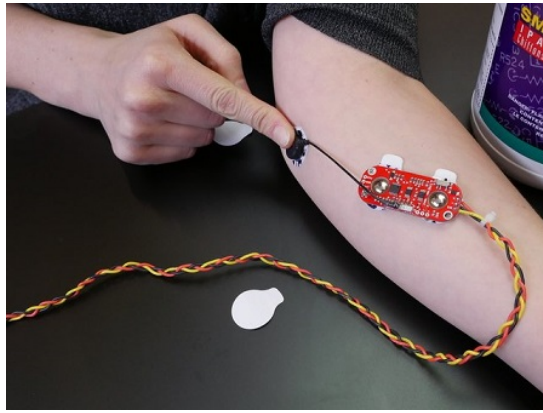

Figure 3. MyoWare Muscle Sensor

hand. The experiment followed two steps:

Firstly, in "Fixed" typing method, the users were told to type a certain paragraph exactly as it is in a "Relaxed" state. The users were shown pictures that induce relaxing features of ones mind. They listened to soothing music for about one minute. On the computer screen a paragraph was displayed taken from the famous children's novel *Alice's adventures in wonderland*(Carroll 2008)According to Epp et al.(2011) (Epp, Lippold, & Mandryk, 2011) The reasons behind choosing these text excerpts

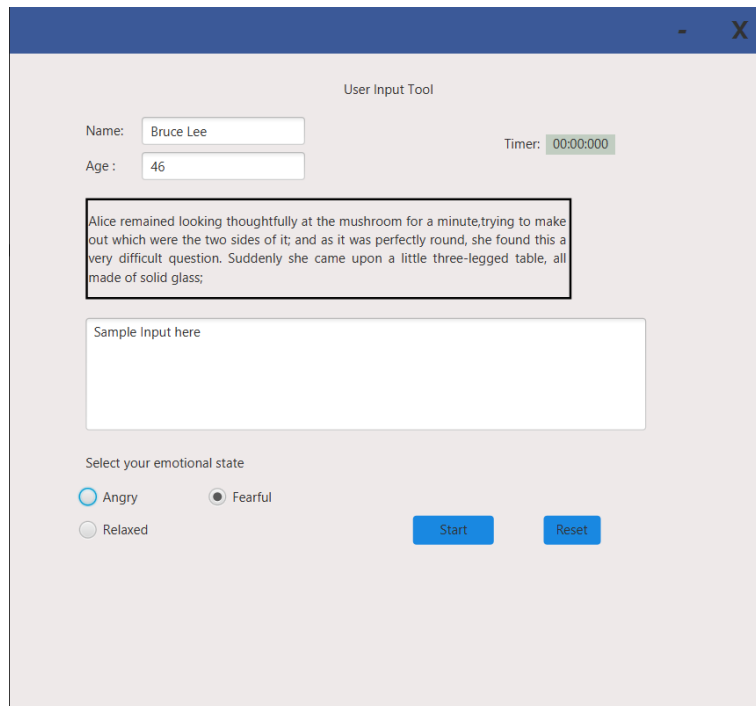

Figure 4. User Input Tool

are that they have relatively simple sentence structure, an absence of large uncommon words and that each piece of text is roughly the same length. The raw data from the sensor along with the timing was recorded. The users were again told to type the

passage but this time in a "Angry" emotional state. They were shown anger inducing picture on the computer screen.

In the "Open" typing stage, the users were told to type anything they want for one minute in Relaxed and Angry emotional state consecutively. Again the raw sensor readings were recorded.

The reason for choosing this type of experimental setup is that, while typing, the muscles of forearm and fingers are most active and the responses can be accurately collected.

Figure 3 shows the input interface tool that was used to conduct the experiment.

3.3. Raw EMG Data

The sensor readings were collected from the Arduino software and saved it into excel using the terraterm software. The sensor readings are integer values ranging from 0 to 999.

We can see from Figure 4 that, in 'relaxed' data it follows a simple pattern with very

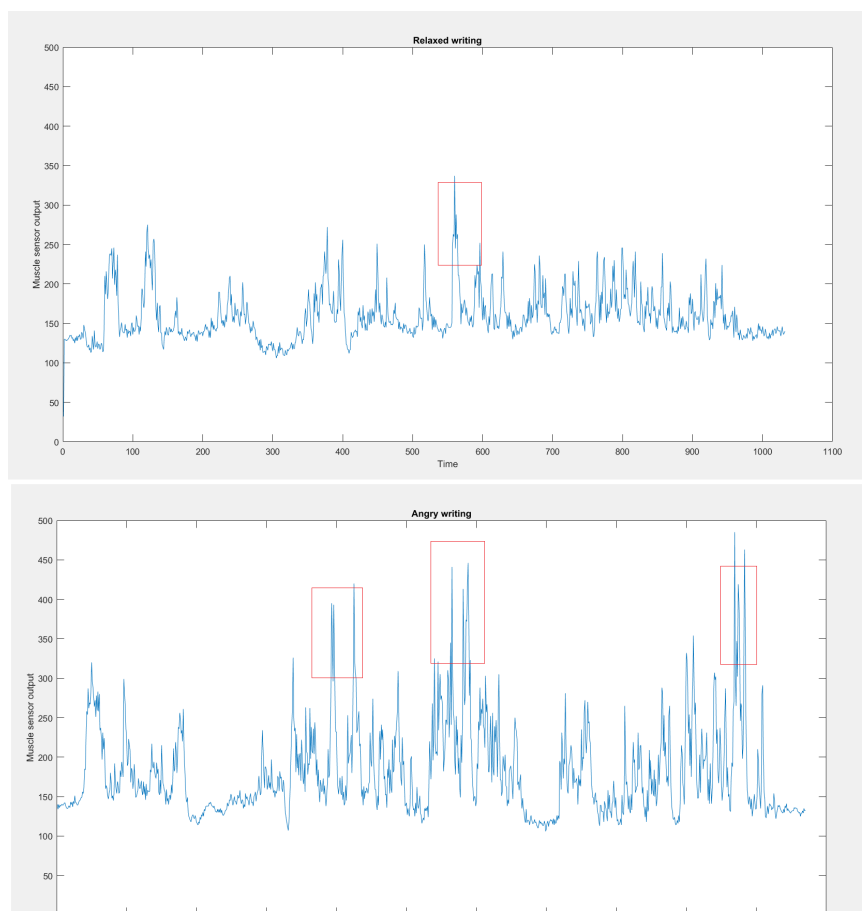

Figure 5. Raw EMG Data Showing Relaxed and Angry state

few spikes (highlighted in red). The signal is kept at a normal level and it shows that human muscles stay at a stable pace throughout. In the raw angry emg data from the user, it is apparent from the naked eye that the pattern is not similar. It has more spikes and ups and downs from the relaxed one. So we can guess that if this data is

fed into the machine to report for a pattern, we may find it.

3.4. *Filtering*

The MyoWare sensor has some built in filtering mechanisms to reduce noise which makes it the ideal device to capture muscle data. In our experiment, we told the users to not type anything for the first 10 seconds and the last 5 seconds after they have done typing the paragraph. Our initial filtering process includes the reduction of those irrelevant data from the raw ones.

3.5. *Feature Extraction*

To perform any machine learning approach, we have to generate features first. Features are characteristics of any dataset. But different types of features can be taken, from that which ones we consider is the key thing to do. From papers regarding feature extraction from EMG or EEG signal, it is understood that features are divided into two domains: Time domain and Frequency domain (Reaz et al., 2006).

But frequency domain features create redundancy while doing classification as we see in (Phinyomark, Phukpattaranont, & Limsakul, 2012). So we have selected the following 8 features from time domain:

- **Maximum Peak in a Timespan:** This means in a specific timespan what is the maximum peak of raw data
- **Mean Absolute Value:** Mean absolute value (MAV) is one of the most popular used in EMG signal analysis. There are many given names for calling this feature; for instance, average rectified value (ARV), averaged absolute value (AAV), integral of absolute value (IAV), and the first order of v-Order features (V1). MAV feature is an average of absolute value of the EMG signal amplitude in a segment
- **Mean Absolute Value Slope:** Mean absolute value slope (MAVSLP) is a modified version of MAV feature to establish multiple features. Differences between MAVs of the adjacent segments are determined.
- **Picks Above Average Frequency:** This means how many peaks are there above the average frequency
- **Root Mean Square:** Root mean square (RMS) is another popular feature in analysis of the EMG signal. It is modeled as amplitude modulated Gaussian random process whose relates to constant force and non-fatiguing contraction. It is also similar to standard deviation method
- **Average Amplitude Change:** Average of how many times amplitudes change in a timespan signal
- **Difference Absolute Standard Deviation Value(DASDV):** Difference absolute standard deviation value (DASDV) is look like RMS feature, in other words, it is a standard deviation value of the wavelength
- **Waveform Length:** Waveform length (WL) is a measure of complexity of the EMG signal. It is defined as cumulative length of the EMG waveform over the time segment. Some literatures called this feature as wavelength (WAVE).

Among these features some are selected from (Phinyomark et al., 2012) and some features such as Maximum Peak in a Timespan, Picks Above Average Frequency, Avg

Amplitude Change are selected from our own intuition. We believe these features are closely related with electromyography signal deviations when users move from one emotional state to another.

3.6. Training Data

We have in total 10 users, from each user we have collected 4 types of data. They are: Fixed Relaxed (Relaxed data collected in fixed format), Fixed Angry, Open Relaxed, Open Angry. There are 40 types of data or 40 "rows" in the training data matrix. Each data is divided into 10 time slots. In each time slots there are 8 features. So there are 80 features in total per row. In total the matrix size is 40x80. The process is described in the Figure 6

The matrix(Figure 7) looks like the following in MatLab:

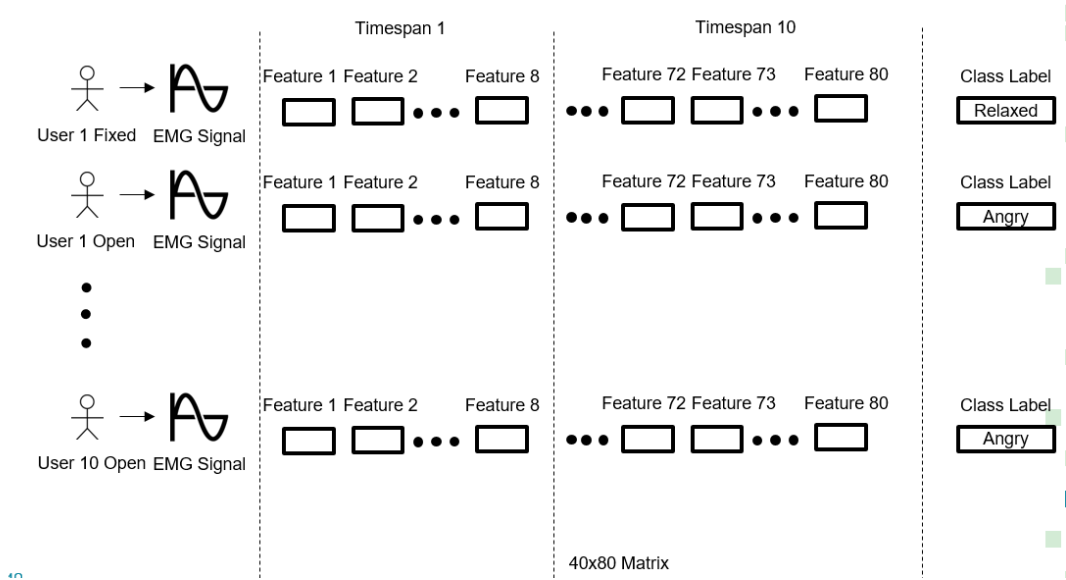

Figure 6. Feature Collection Process

3.7. Selecting Best Features

We see from Figure 7 that, there are 80 features in total per user data. This is a large number which may cause over-fitting of data. So, we made an algorithm that selects the best 5 features that gives the highest accuracy for that specific training data. The algorithm automatically takes 5 feature sets and then calculates. It performs all the combinations and sees which set produces the highest accuracy. Those 5 features are selected for classifying test data. The reason why 5 features are selected is that, it gives the best accuracy overall. We have performed the algorithm using 3,7,9 features but we see that 5 is the minimum number that gives the best overall accuracy.

	1	2	3	4	5	6	7	8	9	10	11	12	13	14	15	16	17	18	19	20	21
1	197.5500	98.7770	167	207	197.8400	1008	3.6298	4.4381	196.9100	98.4530	174	206	197.2000	1076	3.8747	4.6868	265.7600	216.3500	133	440	276.3600
2	194.8800	97.4390	150	224	195.6600	1218	4.3593	5.0186	284.6300	142.3200	119	408	290.9000	1503	5.3794	7.3635	431.1100	347.4100	130	688	454.0300
3	224.3000	112.1500	110	271	224.9400	1117	3.9680	4.6760	237.2800	118.6400	132	297	238.3800	1209	4.2948	5.0315	243.3600	185.2800	140	276	243.9500
4	201.1900	100.5900	161	251	202.8000	1408	4.8468	13.1430	202.2100	101.1100	46	557	228.1700	1256	4.3236	6.6748	225.0500	166.5500	122	502	237.0600
5	181.7000	90.8490	152	202	182.2400	666	2.3559	2.9778	176.8300	88.4170	121	211	177.3400	977	3.4560	4.2578	229.7000	173.6600	144	268	230.7300
6	137.9200	68.9610	157	201	140.9700	852	2.0451	5.5579	132.2900	66.1470	171	189	134.5300	915	2.1964	3.0645	205.5300	175.2300	154	389	230.6600
7	181.7000	90.8490	152	202	182.2400	666	2.3559	2.9778	176.8300	88.4170	121	211	177.3400	977	3.4560	4.2578	229.7000	173.6600	144	268	230.7300
8	137.9200	68.9610	157	201	140.9700	852	2.0451	5.5579	132.2900	66.1470	171	189	134.5300	915	2.1964	3.0645	205.5300	175.2300	154	389	230.6600
9	197.5500	98.7770	167	207	197.8400	1008	3.6298	4.4381	196.9100	98.4530	174	206	197.2000	1076	3.8747	4.6868	265.7600	216.3500	133	440	276.3600
10	194.8800	97.4390	150	224	195.6600	1218	4.3593	5.0186	284.6300	142.3200	119	408	290.9000	1503	5.3794	7.3635	431.1100	347.4100	130	688	454.0300
11	219.2200	109.6100	139	235	219.3700	1773	6.6157	7.7501	233.4700	116.7400	144	258	233.7200	1761	6.5709	7.7766	250.0400	193.4300	140	340	252.0900
12	140.9900	70.4940	142	181	141.7900	715	2.5868	6.8486	287.4000	143.7000	105	621	345.5600	1340	4.8480	7.2995	207.8100	139.7200	106	390	222.9700
13	118.8700	59.4360	144	134	119.5500	430	1.5162	6.1348	113.8500	56.9230	115	130	114.1600	512	1.8054	2.2511	113.0100	83.8290	97	137	113.4100
14	179.1400	89.5700	121	194	179.3100	1148	4.1103	4.7001	176.8100	88.4050	142	191	176.9700	1092	3.9098	4.6517	189.3000	144.3400	80	246	190.2600
15	275.5400	137.7700	169	361	280.9800	1418	5.0499	6.3668	257.1100	128.5500	152	329	259.6200	1441	5.1318	6.1198	274.1600	203.8800	167	351	276.2800
16	211.2600	105.6300	120	271	212.6700	864	3.0094	3.7391	167.9300	83.9670	142	187	168.0900	628	2.1874	2.8230	175.2200	131.8600	137	199	175.4500
17	222.3200	111.1600	112	423	244.6700	916	2.8202	4.3254	153.0200	76.5120	186	206	157.3700	552	1.6995	2.2994	191.6000	143.5600	206	234	196.3200
18	149.7000	74.8510	128	168	150.2000	444	1.6093	2.0577	148.2600	74.1300	126	166	148.7100	580	2.1022	2.7281	154.2900	118.0900	97	185	155.0100
19	222.3200	111.1600	112	423	244.6700	916	2.8202	4.3254	153.0200	76.5120	186	206	157.3700	552	1.6995	2.2994	191.6000	143.5600	206	234	196.3200
20	149.7000	74.8510	128	168	150.2000	444	1.6093	2.0577	148.2600	74.1300	126	166	148.7100	580	2.1022	2.7281	154.2900	118.0900	97	185	155.0100
21	180.2600	90.1300	144	199	180.8800	1112	4.0643	11.4930	192.8800	96.4400	128	218	193.3500	759	2.7741	3.5145	305.4800	232.1900	187	343	307
22	136.2400	68.1190	122	149	136.5700	574	2.1833	2.5357	137.4900	68.7430	122	157	137.9100	593	2.2556	2.7848	242.4500	189.7100	155	326	250.3700
23	146.3600	73.1780	124	174	146.9100	449	1.6250	2.1266	129.1000	64.5510	126	146	129.3600	400	1.4477	1.7879	145.5000	114.2000	135	190	147.5500
24	156.1000	78.0490	140	181	156.9800	862	3.2188	10.7000	210.2000	105.1000	130	301	215.4200	1041	3.8872	4.8272	205.1100	156.6000	153	308	208.2100
25	240.9500	120.4800	128	377	245.3800	1380	4.7293	5.6776	226.5800	113.2900	157	277	228.2100	1172	4.0164	4.8271	208.5900	159.4200	135	267	210.9500
26	203.3600	101.6800	144	224	203.6400	789	2.7880	6.7737	210.7700	105.3900	116	247	211	810	2.8622	3.5937	251.3400	199.0800	87	394	259.4300
27	190.3600	90.3300	144	199	180.8800	1112	4.0643	11.4930	192.8800	96.4400	128	218	193.3500	759	2.7741	3.5145	305.4800	232.1900	187	343	307

Figure 7. Training Data Set

3.8. Classification

We have used two approaches to generate test and train data:

- **Leave One Out:** Here out of 10 users, 1 user was kept aside for test data and the rest 9 were used for train.
- **80-20 Method:** In this approach, 20% of data is selected as random for testing. The rest are training data

In our research we have followed both the techniques.

3.9. Recognition Using SVM

We have used Support Vector Machine with 5 folds cross validation to classify our dataset. Our class labels are "Relaxed" and "Angry". The kernel used is called "Radial Basis Function". The kernel function is a measure of similarity between two sets of features. The SVM algorithm picks up the best 5 features from the 80 feature and matches the features.

In Figure 8, we see the output of the algorithm in matlab for the leave one out method, where the accuracy of that particular iteration was 100%. In total 400 iterations were done and the average accuracy after 400 iterations were 93%. In Figure 9 we see output of the algorithm for the twenty eighty method. The accuracy for that specific iteration was 87.5%. There were in total 400 iterations and the average accuracy was 88%.

3.10. Accuracy

Following the Leave One Out approach we got around 93% accuracy for 400 iterations. And following 80-20 approach we got around 88% accuracy for 400 iterations.

```

Command Window
Selected User for testing : 8
Start forward sequential feature selection:
Initial columns included: none
Columns that can not be included: none
Step 1, added column 38, criterion value 0.0833333
Step 2, added column 7, criterion value 0.0833333
Step 3, added column 31, criterion value 0.0833333
Step 4, added column 32, criterion value 0.0833333
Step 5, added column 39, criterion value 0.0833333
Final columns included: 7 31 32 38 39
ans =
     1     1
     1     1
     2     2
     2     2
test_accuracy_for_iter =
    100
Selected User for testing : 4
Start forward sequential feature selection:
Initial columns included: none
Columns that can not be included: none
Step 1, added column 38, criterion value 0.0277778
Step 2, added column 7, criterion value 0.0277778
Step 3, added column 31, criterion value 0.0277778
Step 4, added column 32, criterion value 0.0277778
Step 5, added column 39, criterion value 0.0277778
Final columns included: 7 31 32 38 39
ans =
     1     1
     1     1
     2     2
     2     2
fx

```

Figure 8. Leave One Out Method

3.11. Confusion Matrix

The confusion matrix for the leave one out method is showed in Table 1.:

From the confusion matrix(Figure 10) we can deduct a few things. The number of

Table 1. Confusion Matrix For Leave One Out Method

		Original	
		Angry	Relaxed
Predicted	Angry	777	88
	Relaxed	23	712

misclassification is less when in case of mistaking angry data for relax data. This is a positive point for our approach. Because this means if the user is angry, in very few cases it will be mistaken for him/her being relaxed. In our application areas for example, when a driver is driving a car, if he gets angry but our system deducts it as a relax emotional state then that creates a problem. The system will allow the driver to continue driving and risk of accident will increase. So it is a good thing that our system has few numbers of misclassification. The confusion matrix for the 80/20 method is shown in Table 2:

In the 80-20 method(Figure 11) we can also see that the misclassification number is

Table 2. Confusion Matrix For 80-20 Method

		Original	
		Angry	Relaxed
Predicted	Angry	1473	331
	Relaxed	76	1320

```

Command Window
Start forward sequential feature selection:
Initial columns included: none
Columns that can not be included: none
Step 1, added column 44, criterion value 0.03125
Step 2, added column 47, criterion value 0.03125
Step 3, added column 48, criterion value 0.03125
Step 4, added column 55, criterion value 0.0625
Step 5, added column 1, criterion value 0.09375
Final columns included: 1 44 47 48 55
Row number | Predicted | Original |
29 | 2 | 2 |
16 | 1 | 1 |
36 | 2 | 2 |
17 | 1 | 1 |
32 | 2 | 2 |
9 | 1 | 1 |
34 | 1 | 2 |
33 | 2 | 2 |
test_accuracy_for_iter =
87.5000
Start forward sequential feature selection:
Initial columns included: none
Columns that can not be included: none
Step 1, added column 21, criterion value 0.0625
Step 2, added column 19, criterion value 0.09375
Step 3, added column 31, criterion value 0.09375
Step 4, added column 47, criterion value 0.09375
Step 5, added column 48, criterion value 0.09375
Final columns included: 19 21 31 47 48
Row number | Predicted | Original |
15 | 1 | 1 |
7 | 1 | 1 |

```

Figure 9. Twenty Eighty Method

very less when mistaking angry data for relax data.

From the confusion matrix we can calculate the following data showed in the Table 3:

The notations used in the table are TP: True Positive, TN: True Negative, P: Total

Table 3. Confusion Matrix Statistics

Measure	Value	Derivations
Accuracy	0.9306	$ACC = (TP + TN) / (P + N)$
Precision	0.8983	$PPV = TP / (TP + FP)$
Sensitivity	0.9713	$TPR = TP / (TP + FN)$
Specificity	0.8900	$SPC = TN / (FP + TN)$
False Positive Rate	0.1100	$FPR = FP / (FP + TN)$
False Negative Rate	0.0288	$FNR = FN / (FN + TP)$
F1 Score	0.9333	$F1 = 2TP / (2TP + FP + FN)$

Positive, N: Total Negative, FP: False Positive, FN: False Negative.

4. Conclusions and Future Works

In this paper, we tried to explore a field of interaction that has yet not been explored. We have tried to find out whether EMG could be a potential method to interact with a system. The results we found were satisfactory but it also has some limitations. The sensor that we used was a low cost one and there were some noise in the raw data. The implications of our research can be vast. As we have established that emotions are significantly related with our muscles, we can argue that we can give this emotional state as an input to computer systems and the system will be able to provide feedback based on users emotional state.

For our future studies we are planning to build a wireless version of our device. Currently the device we are using is wired and it sometimes create problems when moving arm. So if the device is wireless then it will be easy for the users to move their arm freely. Furthermore we are planning to improve our accuracy by using different machine learning algorithms. Next we are planning to build an interactive virtual table tennis application to conduct an experiment. The virtual table tennis application will be played by forearm movement where there will be our device set up on the arm. The users will be able to provide "power" as a feedback to the game. The more the user grips the bat, the more the projectile of the ball will be. We will let our users play both versions of the game and let them decide which method they prefer.

References

- Alenljung, B., Andreasson, R., Billing, E. A., Lindblom, J., & Lowe, R. (2017). User experience of conveying emotions by touch. In *2017 26th IEEE International Symposium on Robot and Human Interactive Communication (RO-MAN)* (pp. 1240–1247).
- Amma, C., Krings, T., Böer, J., & Schultz, T. (2015). Advancing muscle-computer interfaces with high-density electromyography. In *Proceedings of the 33rd annual ACM conference on human factors in computing systems* (pp. 929–938).
- Cheng, B., & Liu, G. (2008). Emotion recognition from surface emg signal using wavelet transform and neural network. In *Proceedings of the 2nd international conference on bioinformatics and biomedical engineering (ICBBE)* (pp. 1363–1366).
- Crawford, L. E., Vavra, D. T., & Corbin, J. C. (2017). Thinking outside the button box: Emg as a computer input device for psychological research. *Collabra: Psychology*, 3(1).
- Daud, W. M. B. W., Yahya, A. B., Horng, C. S., Sulaima, M. F., & Sudirman, R. (2013). Features extraction of electromyography signals in time domain on biceps brachii muscle. *International Journal of Modeling and Optimization*, 3(6), 515.
- Epp, C., Lippold, M., & Mandryk, R. L. (2011). Identifying emotional states using keystroke dynamics. In *Proceedings of the SIGCHI conference on human factors in computing systems* (pp. 715–724).
- Girardi, D., Lanubile, F., & Novielli, N. (2017). Emotion detection using noninvasive low cost sensors. In *2017 seventh international conference on affective computing and intelligent interaction (ACII)* (pp. 125–130).
- Haque, F., Nancel, M., & Vogel, D. (2015). Myopoint: Pointing and clicking using forearm mounted electromyography and inertial motion sensors. In *Proceedings of the 33rd annual ACM conference on human factors in computing systems* (pp. 3653–3656).
- Hossain, R. B., Sadat, M., & Mahmud, H. (2014). Recognition of human affection in smart-phone perspective based on accelerometer and user's sitting position. In *2014 17th international conference on computer and information technology (ICCI)* (pp. 87–91).
- Hui, T., & Sherratt, R. (2018). Coverage of emotion recognition for common wearable biosensors. *Biosensors*, 8(2), 30.
- Huisman, G., & Frederiks, A. D. (2013). Towards tactile expressions of emotion through mediated touch. In *CHI'13 extended abstracts on human factors in computing systems (CHI EA'13)* (pp. 1575–1580). Association for Computing Machinery (ACM).
- Liu, Y., Sourina, O., & Nguyen, M. K. (2010). Real-time eeg-based human emotion recognition and visualization. In *2010 international conference on cyberworlds* (pp. 262–269).
- Mikhail, M., El-Ayat, K., El Kaliouby, R., Coan, J., & Allen, J. J. (2010). Emotion detection using noisy eeg data. In *Proceedings of the 1st augmented human international conference* (p. 7).
- Phinyomark, A., Phukpattaranont, P., & Limsakul, C. (2012). Feature reduction and selection for emg signal classification. *Expert systems with applications*, 39(8), 7420–7431.

- Plutchik, R. (2003). *Emotions and life: Perspectives from psychology, biology, and evolution*. American Psychological Association.
- Reaz, M. B. I., Hussain, M., & Mohd-Yasin, F. (2006). Techniques of emg signal analysis: detection, processing, classification and applications. *Biological procedures online*, 8(1), 11.
- Russell, J. A. (1979). Affective space is bipolar. *Journal of personality and social psychology*, 37(3), 345.
- Salminen, K., Surakka, V., Lylykangas, J., Raisamo, J., Saarinen, R., Raisamo, R., ... Evreinov, G. (2008). Emotional and behavioral responses to haptic stimulation. In *Proceedings of the sigchi conference on human factors in computing systems* (pp. 1555–1562).
- Saponas, T. S., Tan, D. S., Morris, D., & Balakrishnan, R. (2008). Demonstrating the feasibility of using forearm electromyography for muscle-computer interfaces. In *Proceedings of the sigchi conference on human factors in computing systems* (pp. 515–524).
- Saponas, T. S., Tan, D. S., Morris, D., Balakrishnan, R., Turner, J., & Landay, J. A. (2009). Enabling always-available input with muscle-computer interfaces. In *Proceedings of the 22nd annual acm symposium on user interface software and technology* (pp. 167–176).